

Global WiFi Device Manual

Thank You for Choosing to Stay Connected with Global WiFi

Please read this manual before your trip to familiarize yourself with your Global WiFi device.

What's Included in Your Order

*Please make sure to return everything that is included in your order or you may be subject to late fees



Table of Contents

<u>Important Steps Before Departure and Upon Arrival</u>	<u>P3</u>
<u>Device Overview</u>	<u>P4</u>
<u>On-Screen Messages and Features Guide</u>	<u>P5</u>
<u>Understanding Data-Saving Settings</u>	<u>P6</u>
<u>How to Connect to Wi-Fi Using a QR Code</u>	<u>P7</u>
<u>Connecting to Your Global WiFi Device</u>	<u>P8</u>
<u>Setup Instructions for iPhone and iPad Users</u>	
<u>Setup Instructions for Android Users</u>	<u>P9</u>
<u>Setup Instructions for Windows Users</u>	<u>P10</u>
<u>Setup Instructions for Mac Users</u>	<u>P11</u>
<u>Using the Conversion Plug</u>	<u>P12</u>
<u>Safety Guidelines</u>	<u>P14</u>

Important Steps Before Departure and Upon Arrival



Before Departure



Do not use your Global WiFi device before departure; only use it in the destination you specified in your order



Because our Global WiFi device contains a lithium-ion battery, you cannot put it in your checked luggage

【Air Travel】 Luggage regulations

Some airports may regulate the number of lithium batteries carried by passengers.

【Settings】 User Settings

Please make sure you turn off any data roaming functions.

- iPhone(iOS7 and later) 1.Settings ▶ 2.Cellular Data ▶ 3.Off
- Android(Android4.0 and later) 1.Settings ▶ 2.Other Settings(Other Networks) ▶
3.Mobile network settings ▶ 4.Data roaming ▶ 5.Off



Upon Arrival



Turn on your Global WiFi device after arriving at your destination



If we detect an abnormally high amount of data being used on your device, we may implement data speed limits.

Please be mindful especially if you are using the device to connect multiple devices.

In the event of theft, loss, or damage, or if a communication problem occurs, please contact our customer center immediately.



We will only cover the international call charges to customer support team incurred in resolving the communication problem.

If You Have Purchased Our Device Insurance

To apply for compensation in the event of loss or theft, you will need a certificate issued by local law enforcement.
In the event of an emergency, please contact customer support team.

Mail : support@getglobalwifi.com

Device Overview

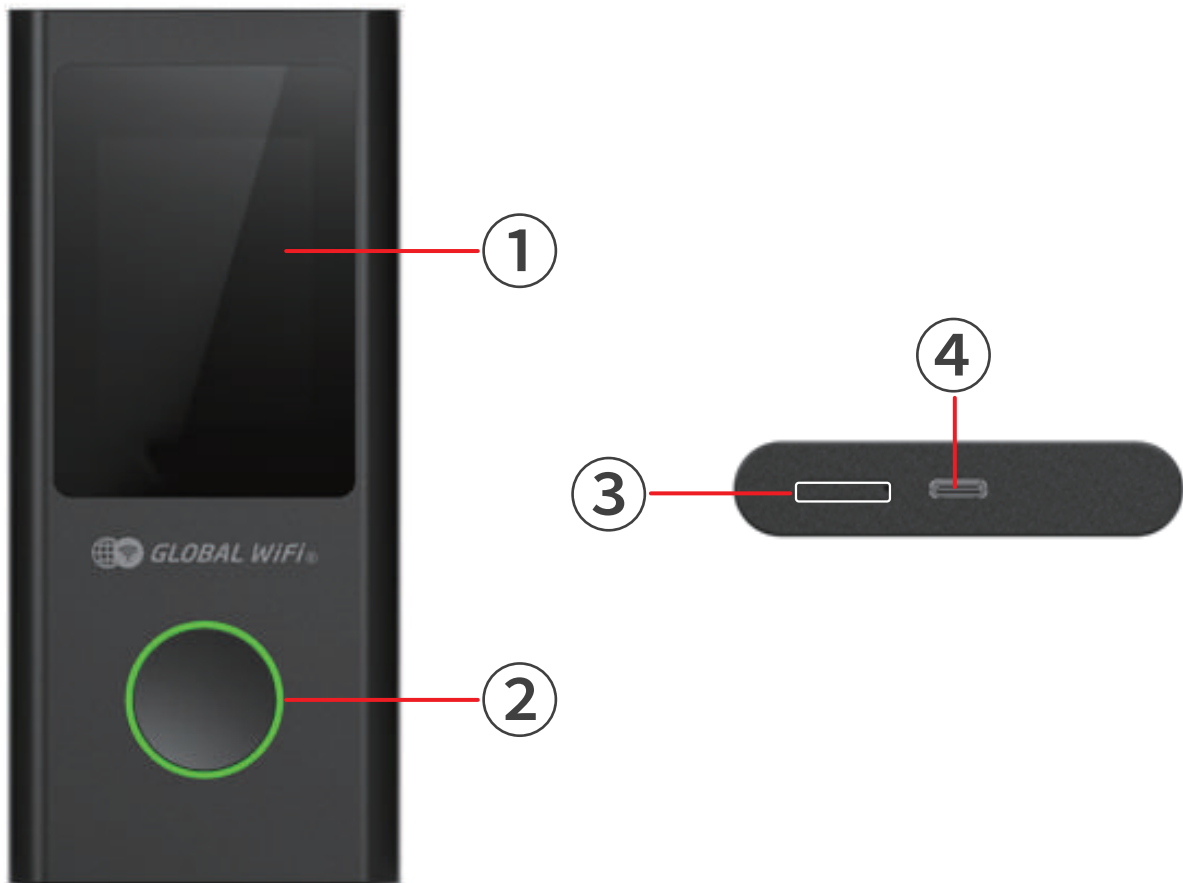

No	Names	Functions
①	LCD screen	Displays the device's status and the amount of data used
		Operates the device. *Touch panel
②	Power button	ON: Press and hold for 3 seconds
		OFF: Press and hold for 3 seconds, then select [Power off]
		Used to turn on the LCD screen from the automatic off state
③	SIM slot	Not used
④	Charging connector	Connect the cable (USB-C) to charge

On-Screen Messages and Features Guide

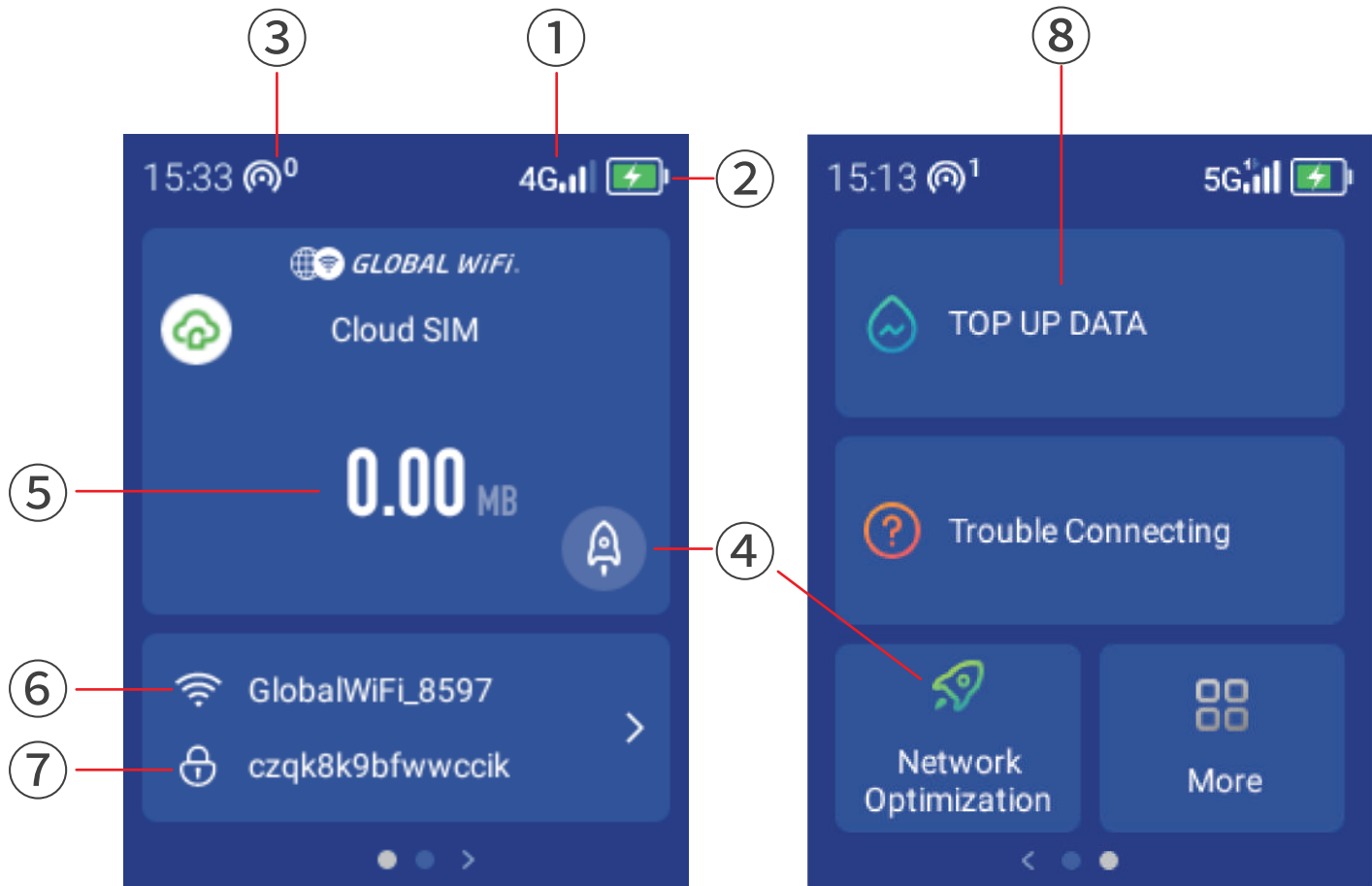

No	Names	Functions
①	Network type	Displays the type of network and the signal strength
②	Battery level	Displays the remaining battery level
③	Wi-Fi connections	Displays the number of devices connected via Wi-Fi
④	Network optimization	Optimizes communication if the speed is slow
⑤	Data usage	Displays the amount of data usage
⑥	Wi-Fi name	Displays the SSID when connected to Wi-Fi
⑦	Password	Displays the password when connected to Wi-Fi
⑧	Top up data	To be implemented

Data Speed Limits for 1 GB and 500 MB Plans

For travelers who have the 1 GB and 500 MB Plans, if you reach your daily data cap, your data speed will be limited to 1 Mbps until midnight Eastern Time.

Understanding Data-Saving Settings

Our Data Usage Protection feature helps prevent excessive data usage without your awareness.

This is particularly important for travelers on 1 GB or 500 MB plans.

It may impact the following apps and functions, which typically consume significant data:

- Downloading and updating apps on the App Store or Google Play
- Syncing with iCloud
- Sending images and videos via iMessage
- Streaming music and videos

To use the above apps and functions,

disable Data Usage Protection by following the steps below:

- ① Select Data Usage Protection from the menu on your screen
- ② Tap the toggle next to Enable off to disable Data Usage Protection
- ③ Select the time you want to set ⇒ Tap [OK]

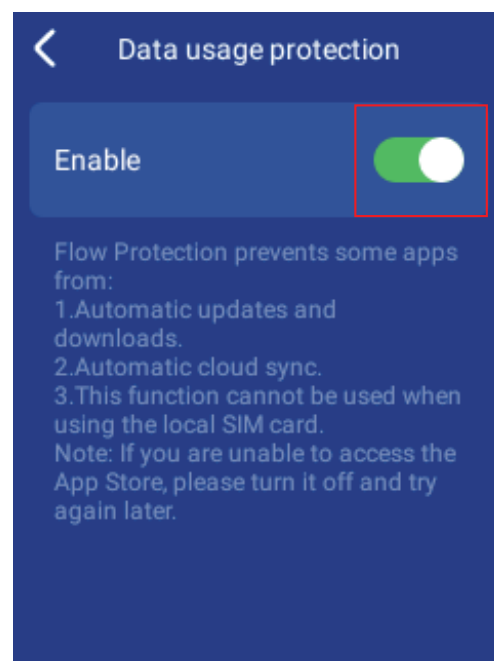
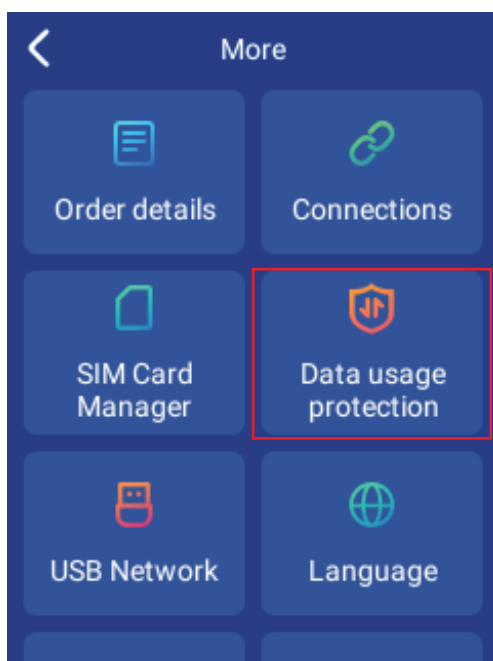

[FYI]

- Data Usage Protection will automatically be enabled when you restart your device
- Data Usage Protection' s default setting cannot be disabled
- Disabling Data Usage Protection can result in excessive data usage

How to Connect to Wi-Fi Using a QR Code

The most convenient way to connect to your Global WiFi device is via QR code by following the below steps:

- ① Tap on the bracket at the bottom right of your screen, next to the SSID and password
- ② Tap the QR code icon next to the SSID and password
- ③ Read the QR code with the camera app on your personal electronic device you'd like to connect

*If you cannot connect via the QR code, try connecting with the SSID and password. Depending on your personal electronic device, the QR function may be unavailable

*For Android users, if you cannot read it with the camera, please use a QR code reader app

*Connecting multiple devices can lower the speed of your Wi-Fi

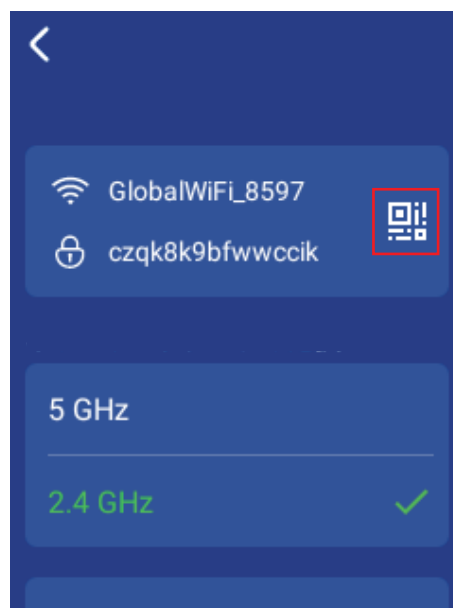
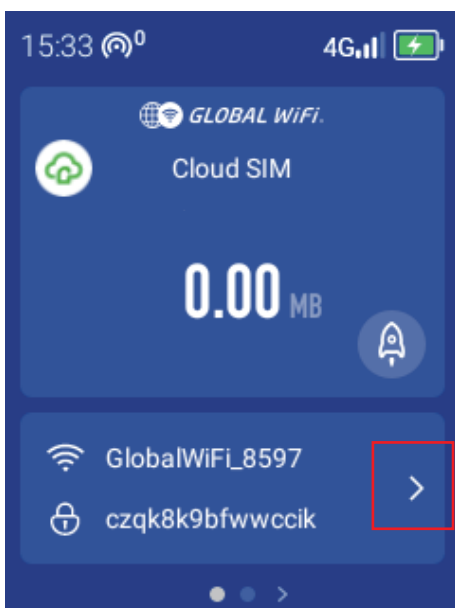

Connecting to Your Global WiFi Device

Here is a guide on how to connect each device to Wi-Fi. Please pay attention to the following commonly mistaken characters when checking the SSID and password.

《Commonly Mistaken Characters》

- Zero "0" •One "1" •Eight "8"
- Lowercase "o" •Uppercase "l" •Uppercase "B"
- Uppercase "D" •Lowercase "l"

Setup Instructions for iPhone and iPad Users

1 Wi-Fi Connection Settings

Open the following screens: Home Screen > "Settings" > "Wi-Fi."



① Turn on Wi-Fi.

*If the circle is spinning, the device is searching for networks.

② The SSID listed on your Wi-Fi device will appear in the list.

Select the SSID, and the screen will change to prompt you for the password. Refer to the sticker on your Wi-Fi device or the screen of the Wi-Fi device to enter the password, then select "Connect" in the top right corner. Once the screen switches and a checkmark appears, the connection is complete.

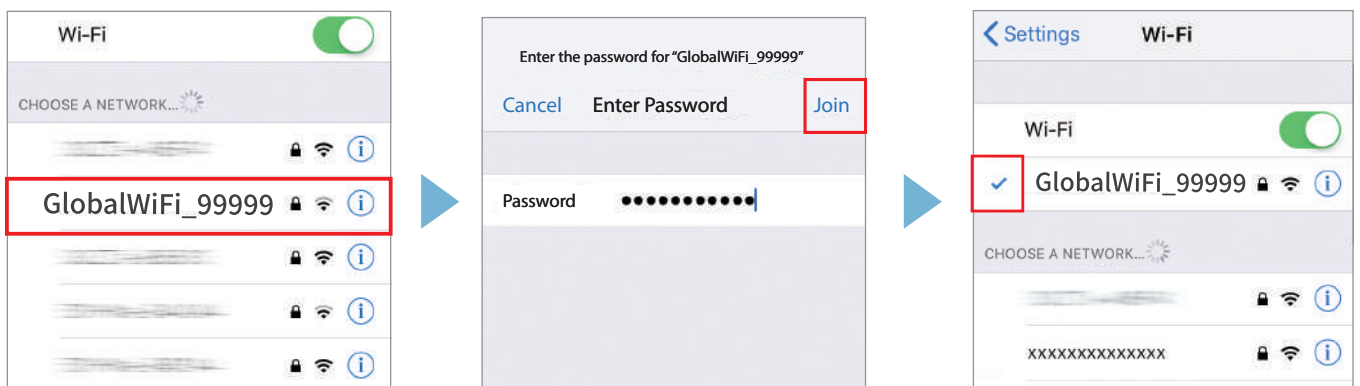

Setup Instructions for Android Users

1 Wi-Fi Connection Settings

From the Home Screen, tap on "Settings" > "Wi-Fi."

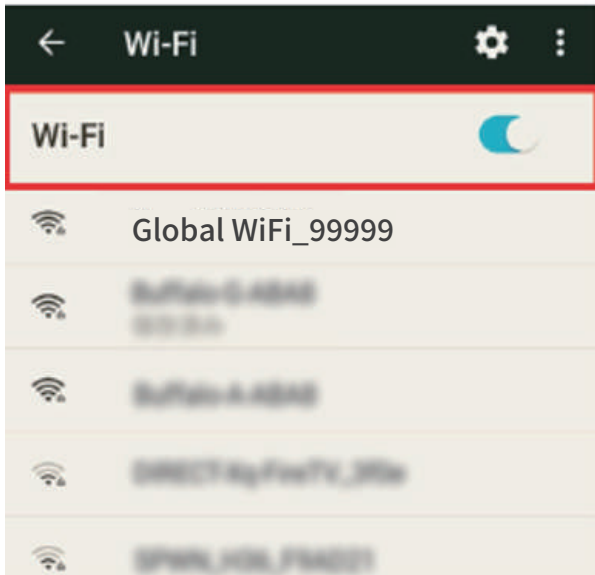

1 Turn Wi-Fi "On."

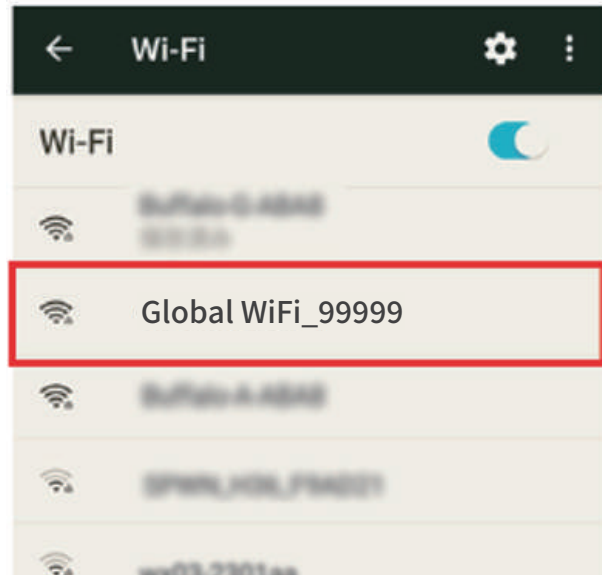

2 Tap on the SSID you want to connect to.

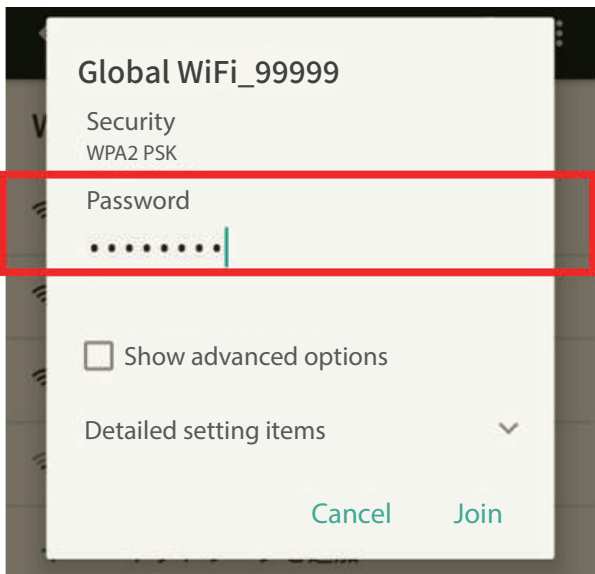

3 Enter the password.



4 Once it shows "Connected," the connection is complete.

Setup Instructions for Windows Users

1 Wi-Fi Connection Settings

Click the "Internet Access" icon displayed in the bottom right "Task Tray" of the desktop.



1 Click the Wi-Fi icon to open the ribbon.

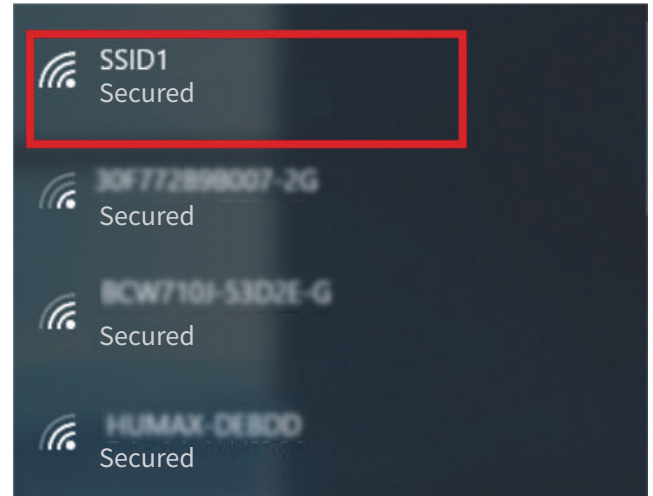

2 Select the SSID you want to connect to.

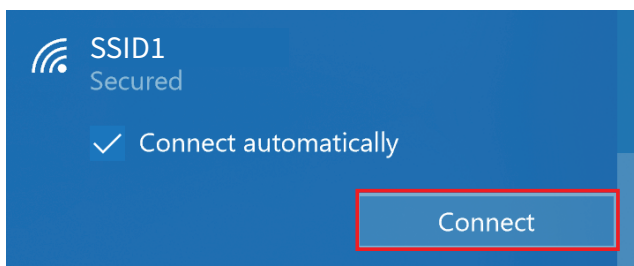

3 After selecting the SSID, checkboxes and a "Connect" button will appear.

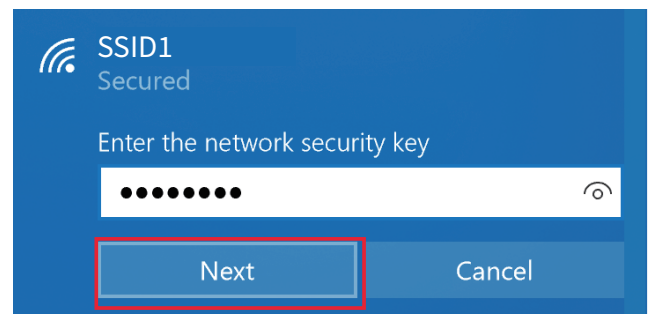

4 A screen prompting you to "Enter the network security key" will appear. Enter the PASS listed on your Wi-Fi device and click "Next" to complete the connection.

Note: This guide assumes that the wireless connection on your device is enabled. If you are unsure about enabling the wireless connection, please contact the manufacturer.

Setup Instructions for Mac Users

1

Wi-Fi Connection Settings

Click the Wi-Fi icon (Air Mac) in the status bar of your device.

Available



Unavailable



If it is unavailable, Wi-Fi may be turned off.
After clicking, select "Turn Wi-Fi On."



- 1 A list of available networks will appear.
Please select the SSID that matches the one listed.



- 2 You will be prompted to enter the password.

Using the Conversion Plug

How to use it

There is no voltage conversion function

Depending on your travel destination or place of stay, the plug shape may not be as specified. Please think of this as a guideline.

I I A USA / Canada / Mexico / Caribbean / Japan / Taiwan etc.

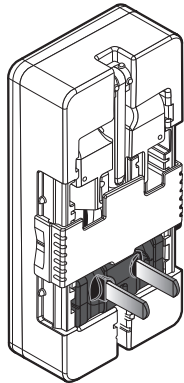

■ BF UK / China / Hong Kong / Thailand / Malaysia / Singapore etc.

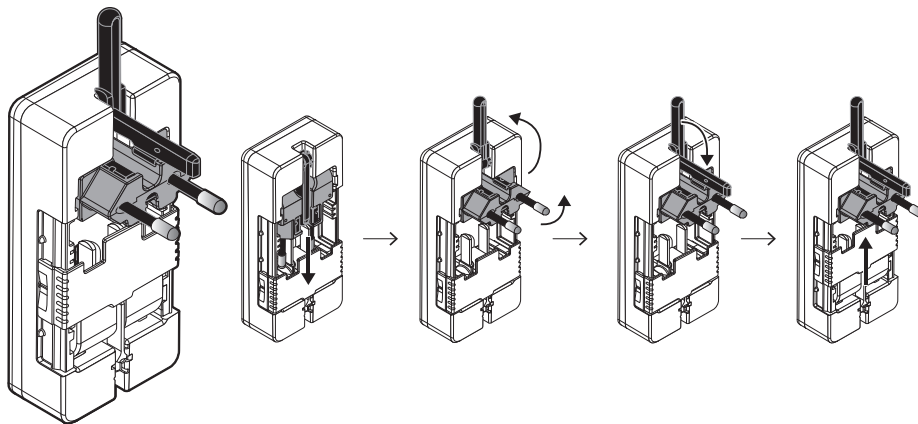

● B3 China / Hong Kong / India / Macau / Malaysia etc.

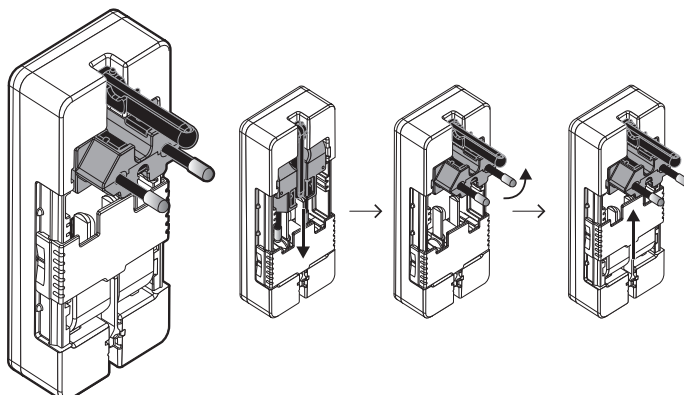

C/B/SE Italy / France / Germany / Spain /
Korea / China / Indonesia etc.

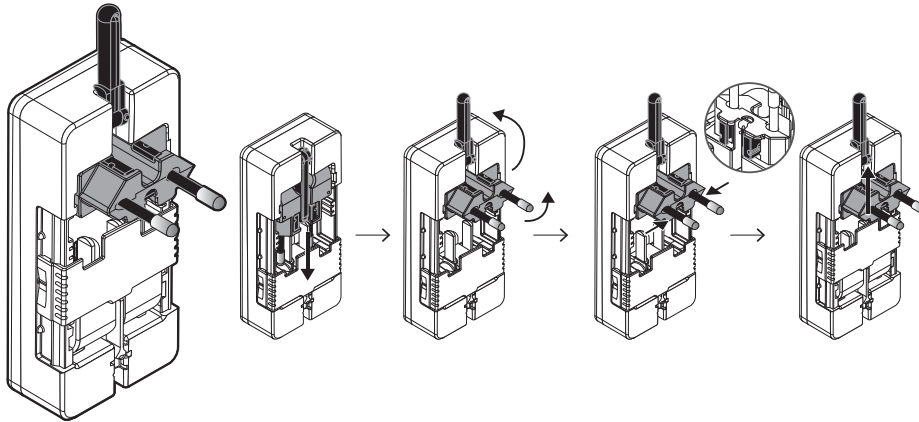

Philippines / Australia / New Zealand etc.

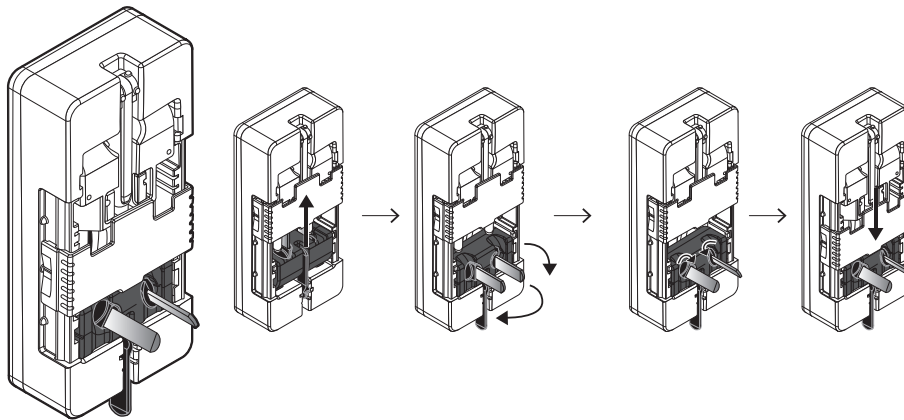



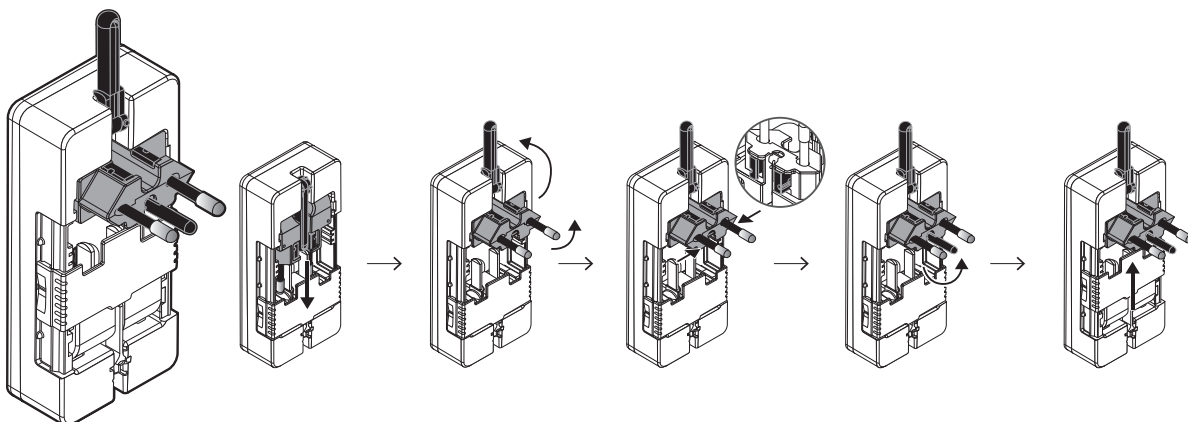

CB Brazil etc.



Safety Guidelines





This "Safety Precautions" contains the contents for any license to prevent from damage to property and information about using safely and correctly the product. Please be sure to read.
 The following classification of each symbol, which describes the extent of the harm or damage, explains when you use the product if you have ignored this precautions.
 Classification of symbols below describes what you keep in mind about precautions.

Explanation of symbols

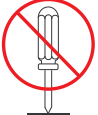

	<p>Prohibitions: This symbol shows the prohibitions in the usage of the product (Do not do it).</p>
	<p>Disassemble: This symbol shows not to disassemble the product. If you do , it is possible a risk of injury.</p>
	<p>Caution wet: This symbol shows not to exposed to the water. There is a risk of electric shock or fire due to leakage and wet in the water.</p>
	<p>Wet hands prohibited: This symbol shows not to touched with wet hands .There is a risk of electric shock when treating the products with wet hands.</p>
	<p>Instruction: This symbol shows the instructions of the usage of the product.</p>

Notes Device Body & Internal Battery



⚠ Risks

 Prohibitions	<p>Do not use the product at a place exposed to direct sunlight and leave the product in the car when it is, hot weather, near a heater or in a place subject to high temperatures. It may cause malfunction, overheating, fire, and deformation of the device. The product also becomes hot, it may cause burns.</p> <p>Please do not use near heat or high-precision electronic devices. May affect the operation of electronic equipment (such as fire alarms, automatic doors and other electric appliances and medical hearing aids, heart pacemakers). If you are using, consult your dealer or the manufacturer.</p>
	<p>Disassemble: Please do not heat, disassemble, modifications. It may cause damage or fire, injury, electric shock. Modification of the product is a violation of the law.</p>
	<p>Wet hands prohibited: Please do not touch with wet hands. It may cause electric shock or malfunction.</p>
	<p>Caution wet: Please do not put in the water. It may cause malfunction, overheating, fire, or electric shock. Please do not use in a place where there is a risk, such as near the glass, liquid spills. If liquid is spilled, it may cause malfunction, overheating, fire, or electric shock.</p>
 Instruction	<p>Please do not use nothing but the specified AC adapter for charging.</p> <p>When battery fluid leaks, and it get an eyeful, please wash your eye with clean water and please get treated immediately by a physician. There is a risk of blindness.</p>

⚠ Warning

 Prohibitions	Please do not drop from a high place, and make a strong shock. It can cause equipment failure, fire, or people's injury as fever.
	Please do not contact the conductive foreign substance to USB connector and insert foreign objects in the gap of USB connector. It may cause malfunction, overheating, fire, or electric shock.
	Please do not use the product in an area where is flammable gas station, etc It may cause an explosion or fire.
	Do not place in a high-pressure vessel, such as a microwave oven and cooking equipment, Please do not place it on an electromagnetic cooker. It may cause of the failure or malfunction.
	Please only use the devices which are included this package. Do not use a device other than those specified .It may cause overheating ,fire ,explosion or other damage .
	Please do not use in locations that are prohibited, such as an airplane or in a hospital. It may affect electronic device or medical equipment. It will be the cause of the accident.
	If you do not use for a long time, please unplug the product from your computer. It may cause an electric shock, fire, or malfunction.
 Instruction	If the product is leaked, please stop using immediately. If you continue to use, it may cause electric shock or malfunction.
	If lightning begins during use at outdoor, please move them to a safe place immediately. It may cause electric shock or lightning.
	The abnormal state of smoke or a strange smell occurs, please remove the product from your computer. If you continue to use, it may cause heat or fire. When you noticed unusualness, please do not use immediately.
	If battery fluid leaks, smell something, please stop using it immediately and move away from the fire.
	If charging is completed for more than a expected charging time, please stop charging.

⚠ Caution

 Prohibitions	Please do not place on where is uneven or shaky, unstable. If you drop the product, it causes malfunction or damage.
	Please do not leave the product close to magnetic card. Magnetic data, such as cash cards, credit cards, telephone cards, floppy disk will be lost.
	Please do not apply excessive force to the product, the SIM card. It may cause malfunction or injury.
	Please do not use other SIM card other than the specified SIM card. If you use a card other than those specified, it may cause data loss or malfunction.
 Instruction	When battery fluid leaks, and it touch your skin or clothing, please wash skin or clothing with clean water immediately.
	Please charge at the range of 0 ~ 35 °C temperature.

Handing of medical electrical equipment

⚠ Warning

Is what "Guidelines on the use of mobile phone terminals, etc. in order to prevent the effects of radio waves on electronic medical equipment," the contents of this description was referring to the contents of the Council (Environment radio).

 Instruction	Please use observe the following in medical institutions. To (CCU) is do not bring the product monitoring room and coronary artery disease (ICU) operating rooms, intensive care. In hospital wards, please turn off the power of the product. Even where they are allowed to use the product, such as the lobby, if you have a medical electrical equipment in the vicinity, please turn off the power of the product. Medical institutions to use individuall. Prohibition for, if you are not allowed, such as defining the location, please follow the instructions of the medical institution.
	If you have installed a defibrillator implantable cardiac pacemakers and implantable, please carry and use more than 22cm away from the incoming charge the product. May affect the operation of pacemakers and implantable cardioverter -defibrillator implantable cardiac by radio waves.
	At the location, such as in a mixture of the crowded train, implantable cardiac pacemakers and planted in the vicinity. There is a possibility that has been installed defibrillators included, please turn off the power to the product. May affect the operation of cardiac pacemakers and implantable cardioverter defibrillator implantable radio waves.
	If the outside of medical institutions, we will be using electronic medical equipment other than implantable cardioverter defibrillators and implantable cardiac pacemaker due to home treatment, please check with manufacturers and other electronic medical equipment individually about the impact of radio waves. It may affect the operation of electronic medical equipment by radio waves.