

Android settings

- Completing setup prior to travelling abroad is recommended.
- Install the app for easy installation of setting profile.
- For the installation without using the app, have your computer or another smartphone in addition to the Android device you are using scan the QR code.
- You can use it from the day you set (activated).
- The display and language may vary in the model and OS version you are using.

STEP 1

For Android settings, please make sure to prepare the following.

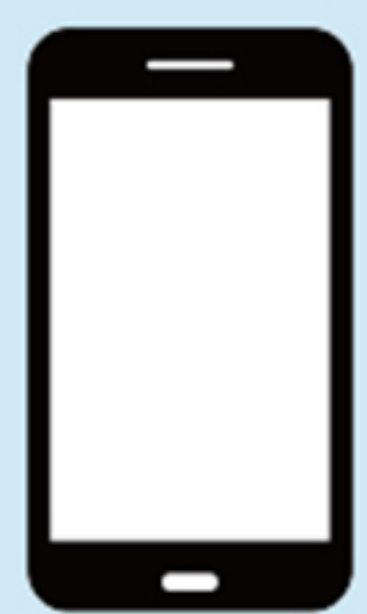

Devices using WorldSIM

Prepare a SIM-free device or a SIM-unlocked device that supports eSIM.



Internet connection such as WiFi

Your device needs to be connected to the internet.



QR code

Will be sent by e-mail after application.



Smartphones, PCs, or tablets*

Required to display the QR code.

*In situations where preparing a separate device to scan the QR code from is difficult, you can send a screenshot to a nearby family member or friend to display the code for you, or print it out.

STEP 2

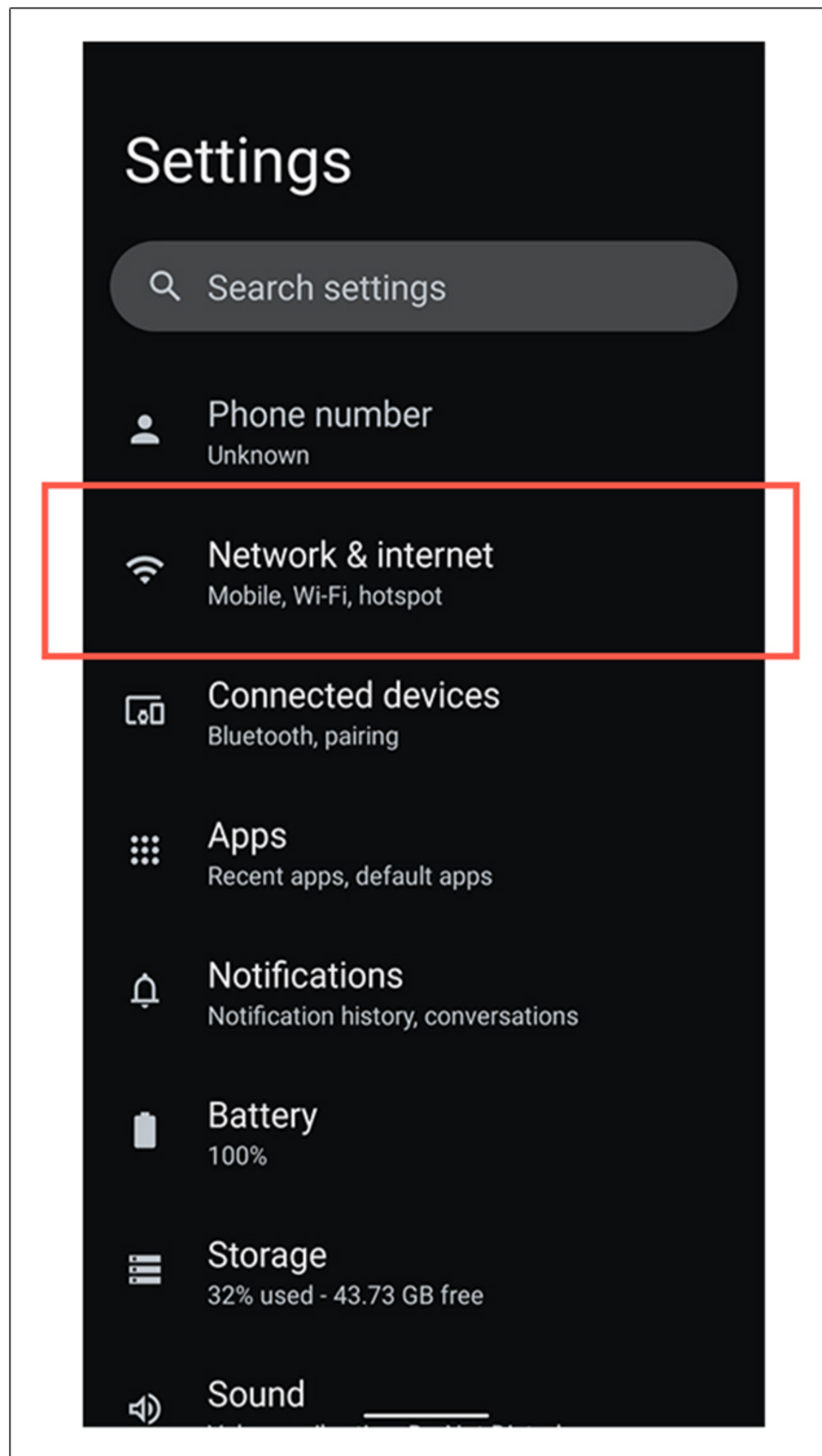

Access settings on your device and tap on "Network & internet".

STEP 3

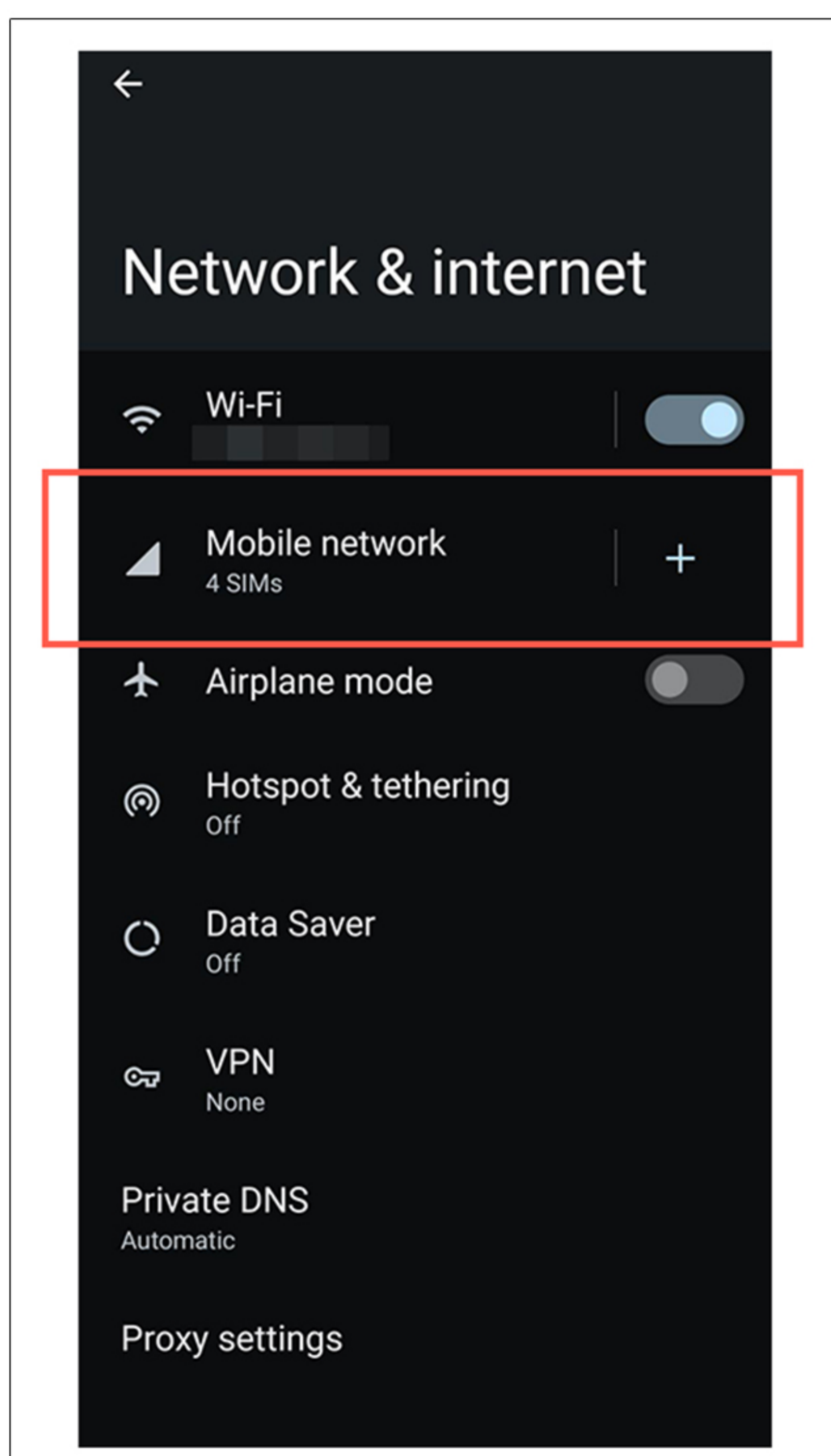

Tap the "+" mark to the side of "Mobile network".

STEP 4

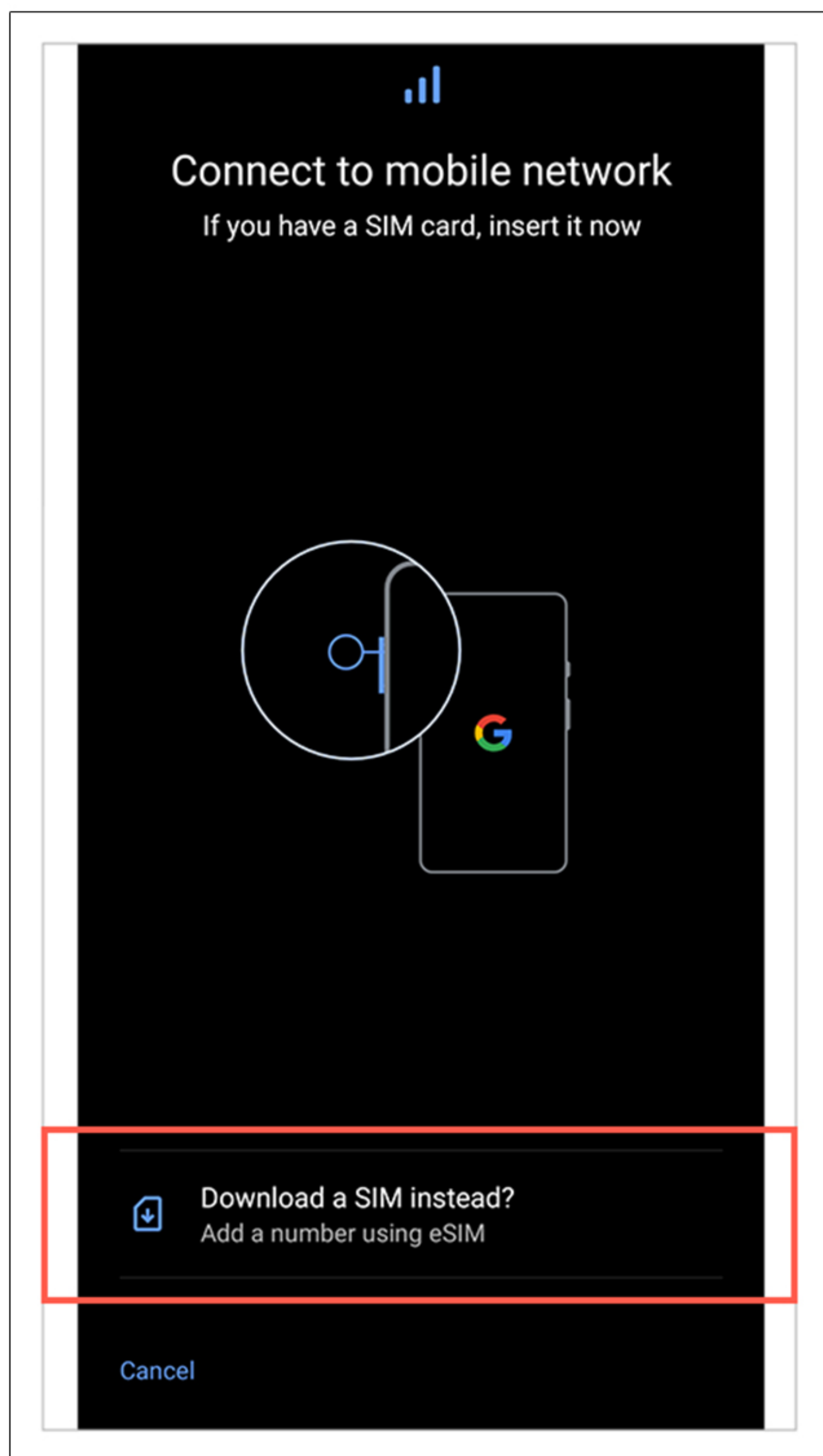

Tap "Download a SIM instead?".

STEP 5

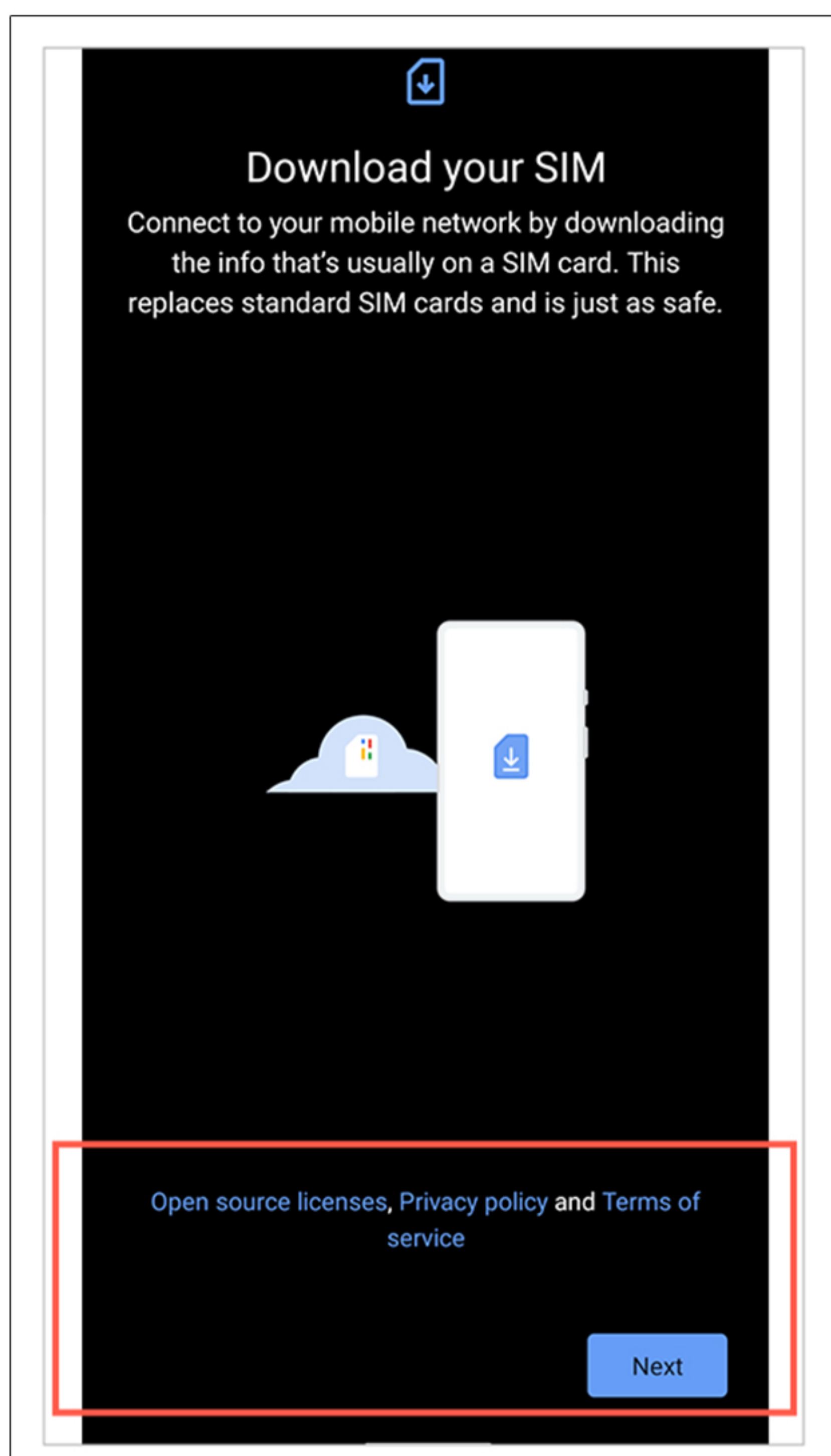

Tap "Next".

STEP 6



Scan the QR code.

STEP 7

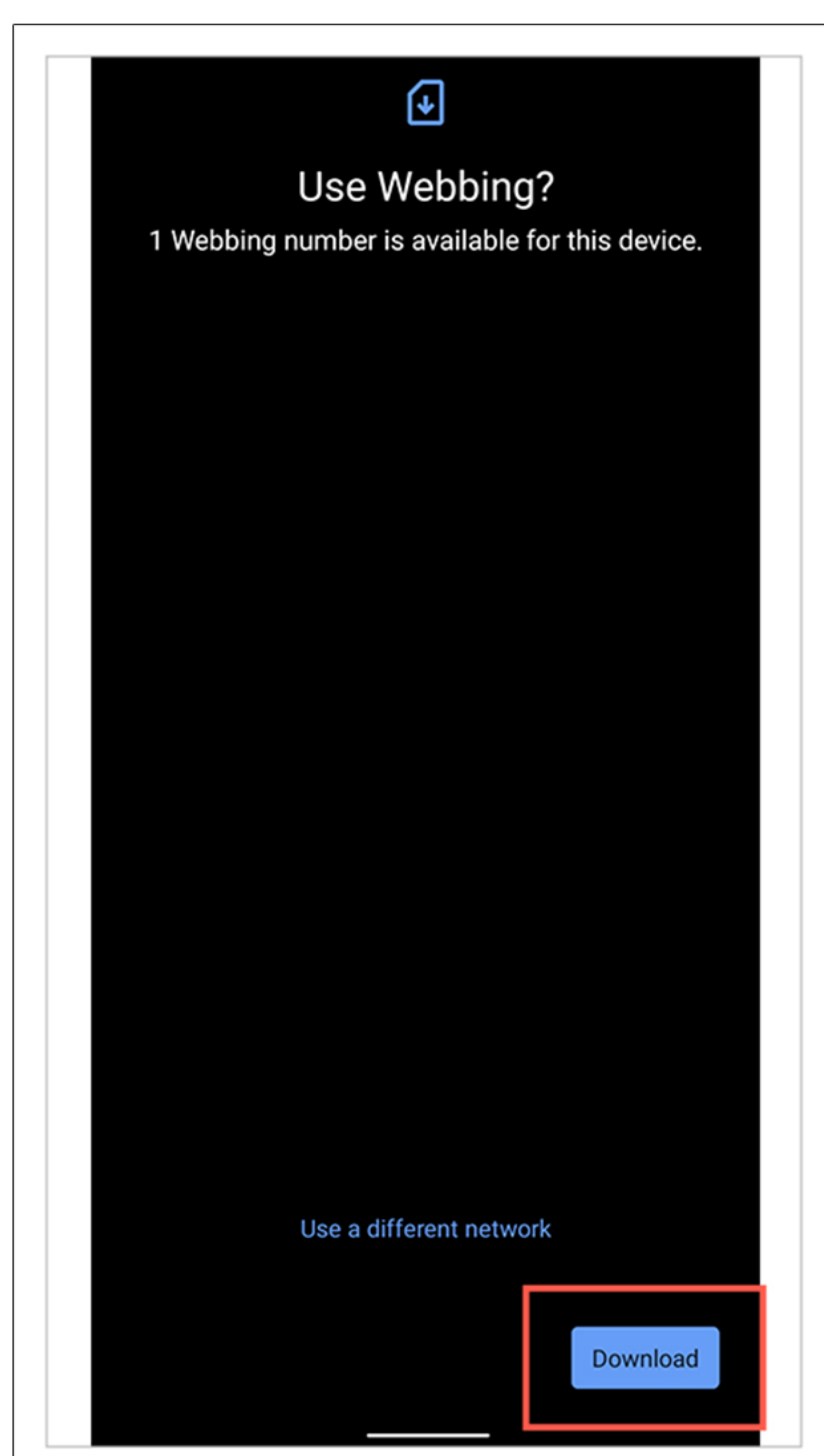

Tap "Download".

STEP 8

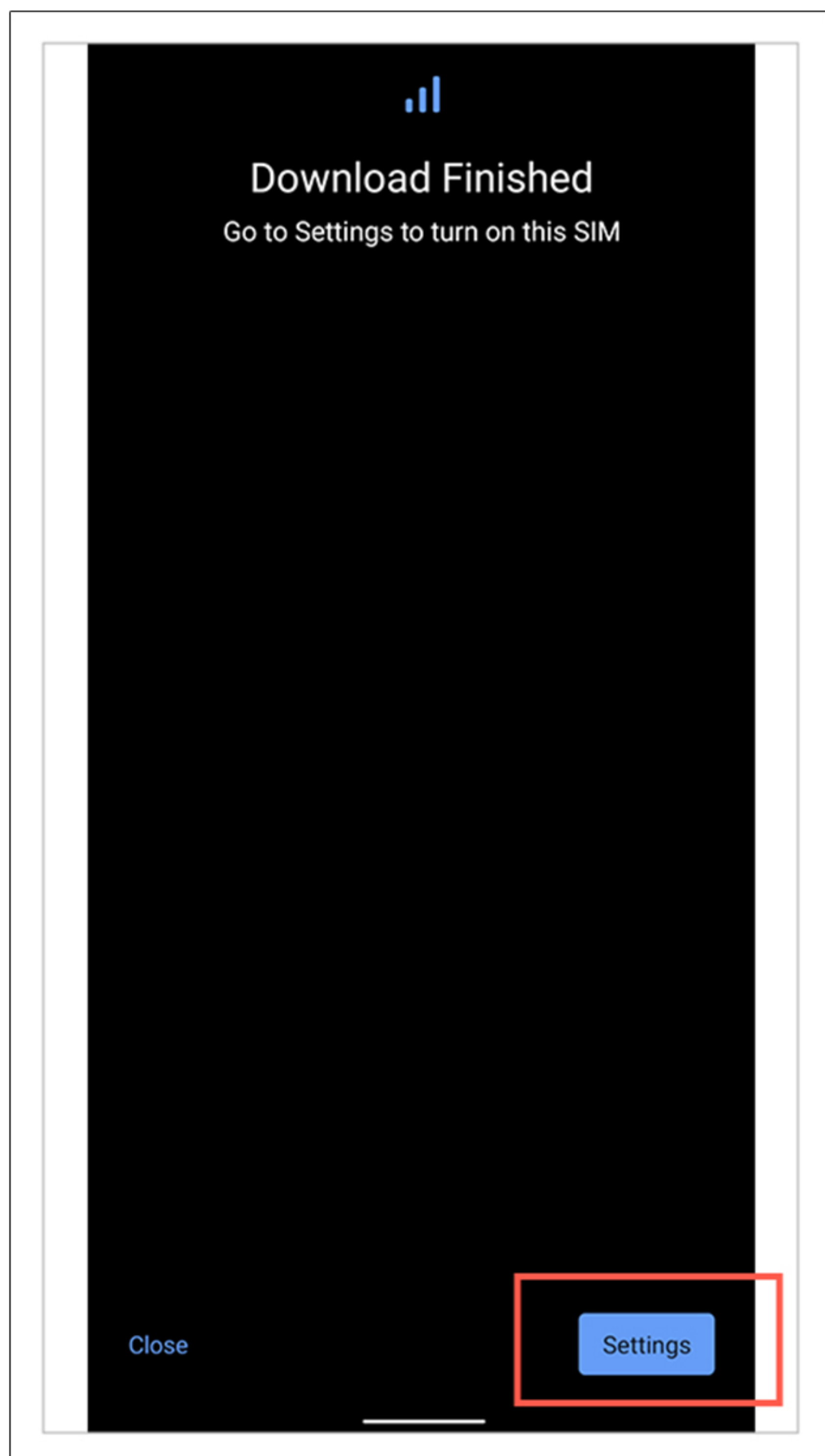

After download is complete, tap "Settings".

 **Installation Complete.**

Installation of World eSIM is now complete. It is highly recommended to complete the steps up until this point prior to departure.



Setup for Using eSIM Abroad

STEP 9

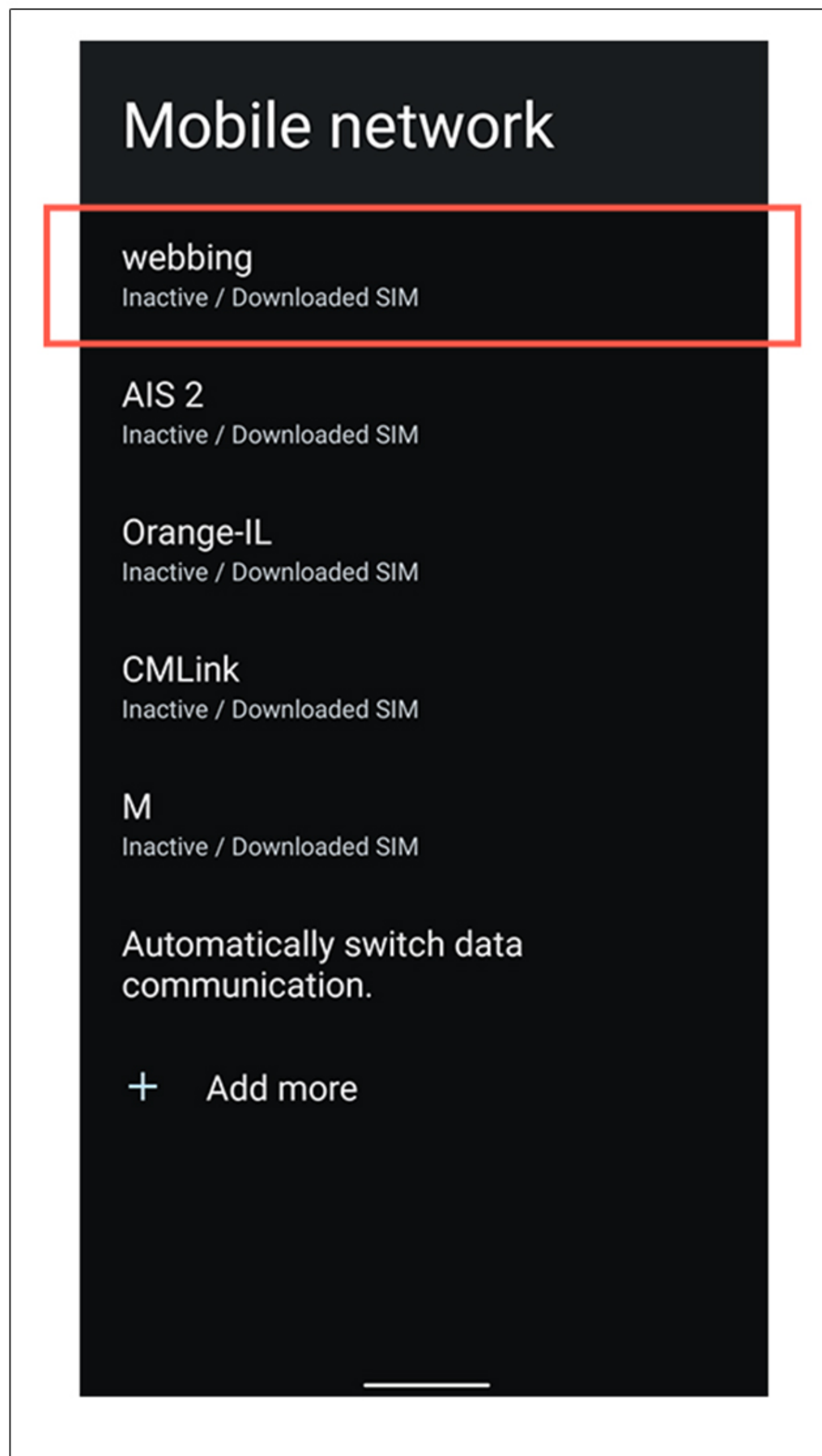

On the settings page, tap "Network & internet" then "Mobile network", and select your newly installed eSIM.

The name of mobile network may vary depending on your plan.



STEP 10



Enable "Use SIM".

STEP 11

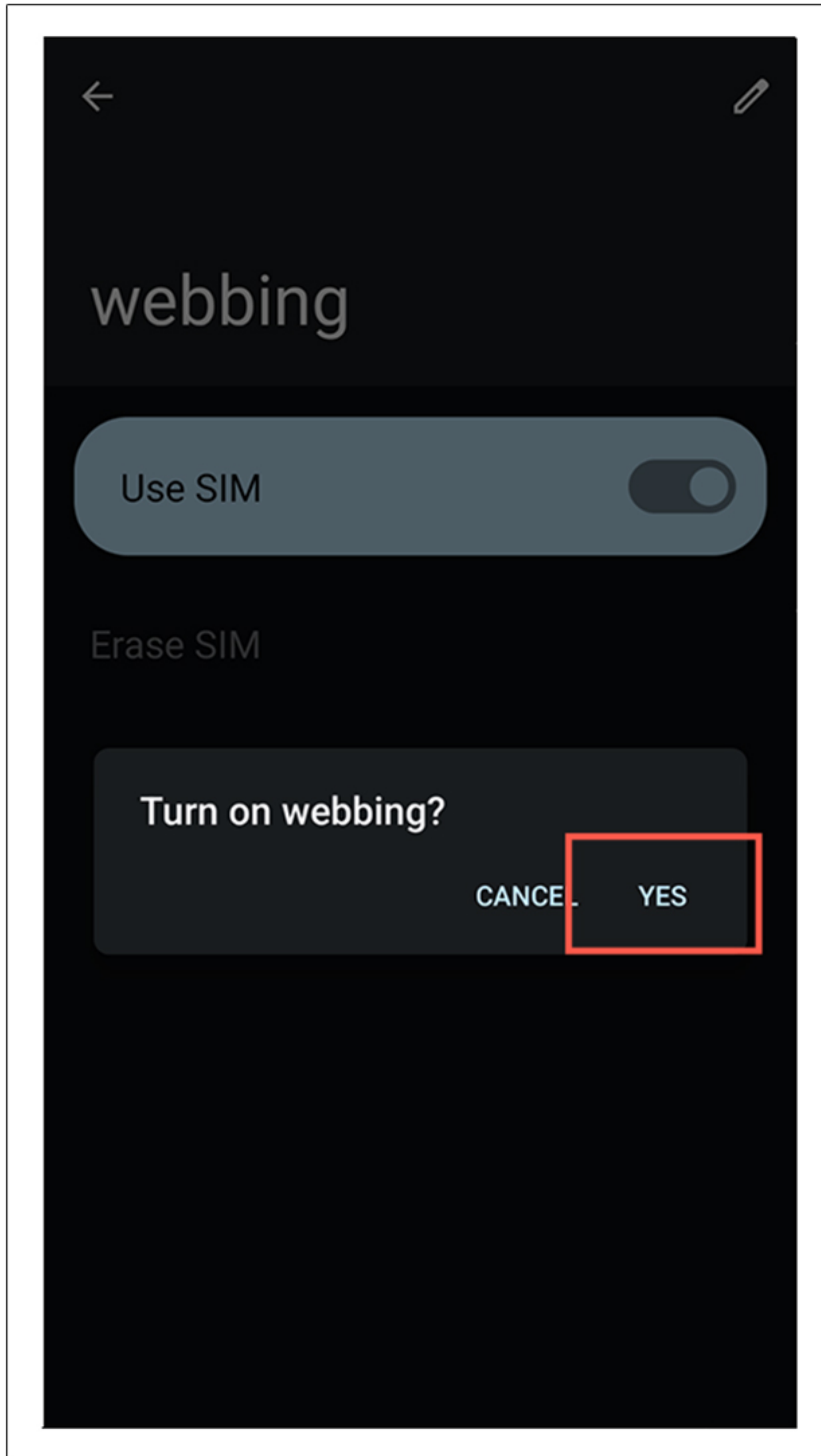

Select "YES".

STEP 12

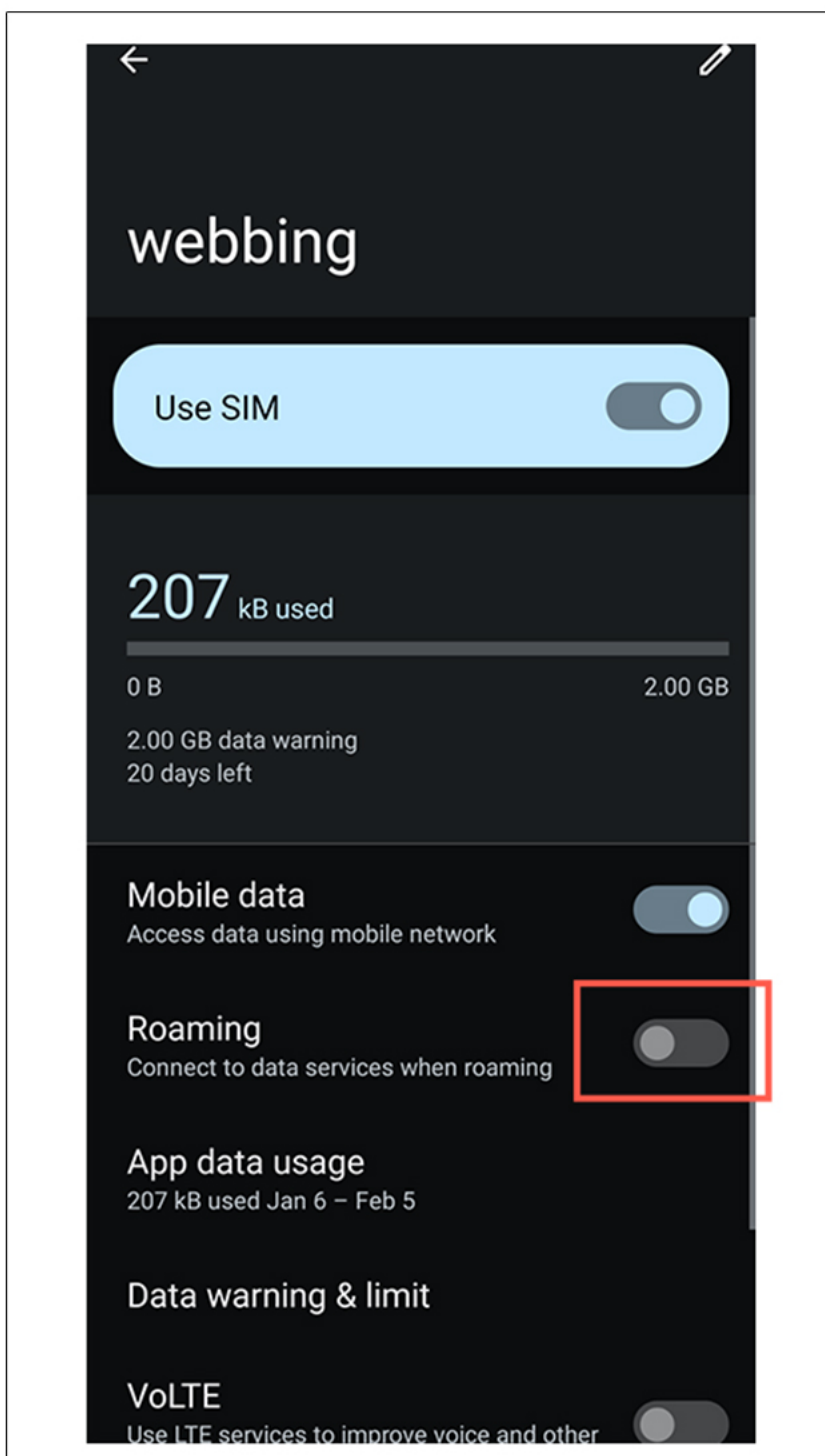

Enable "Roaming".

STEP 13

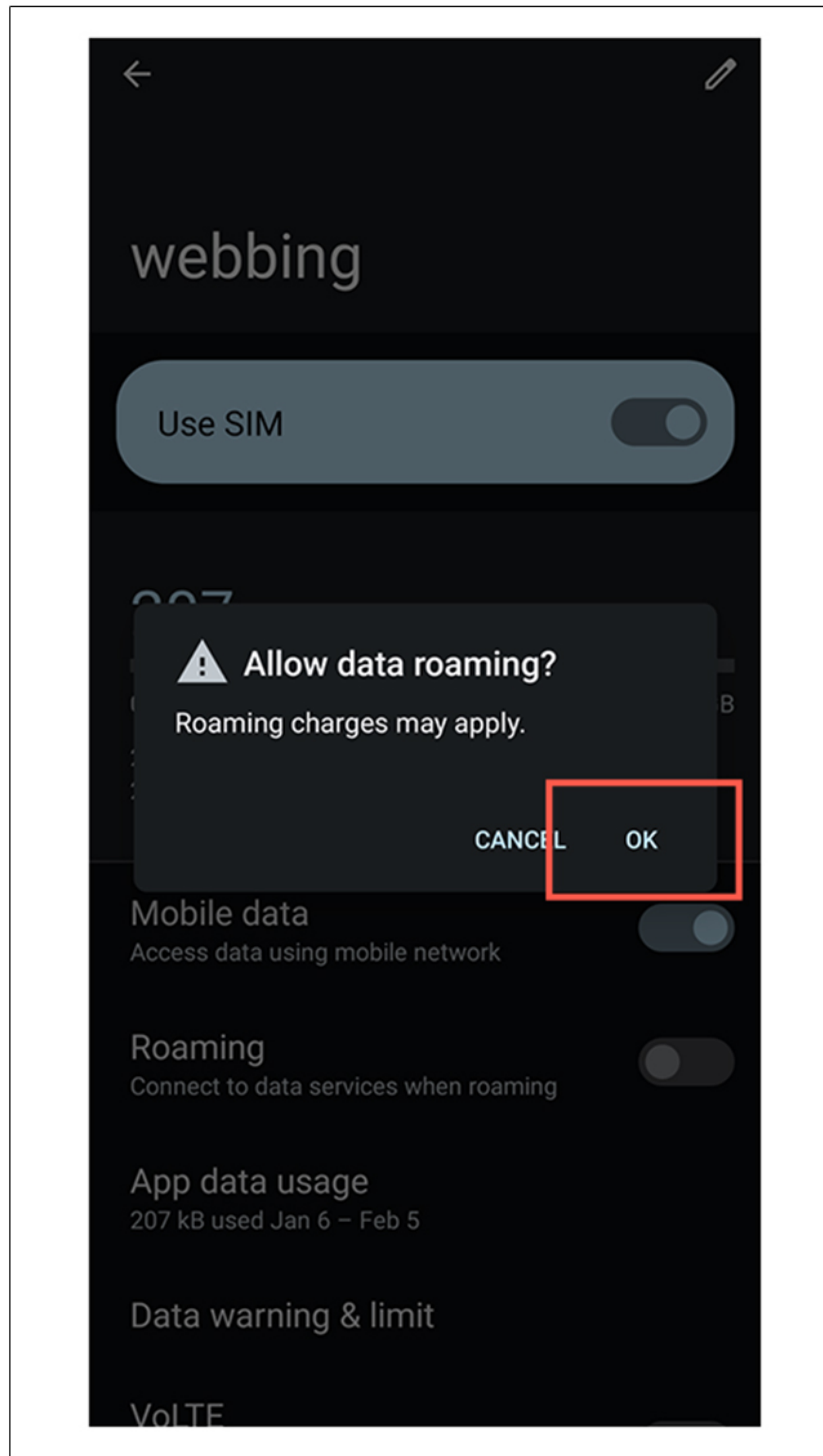

Select "OK".

STEP 14

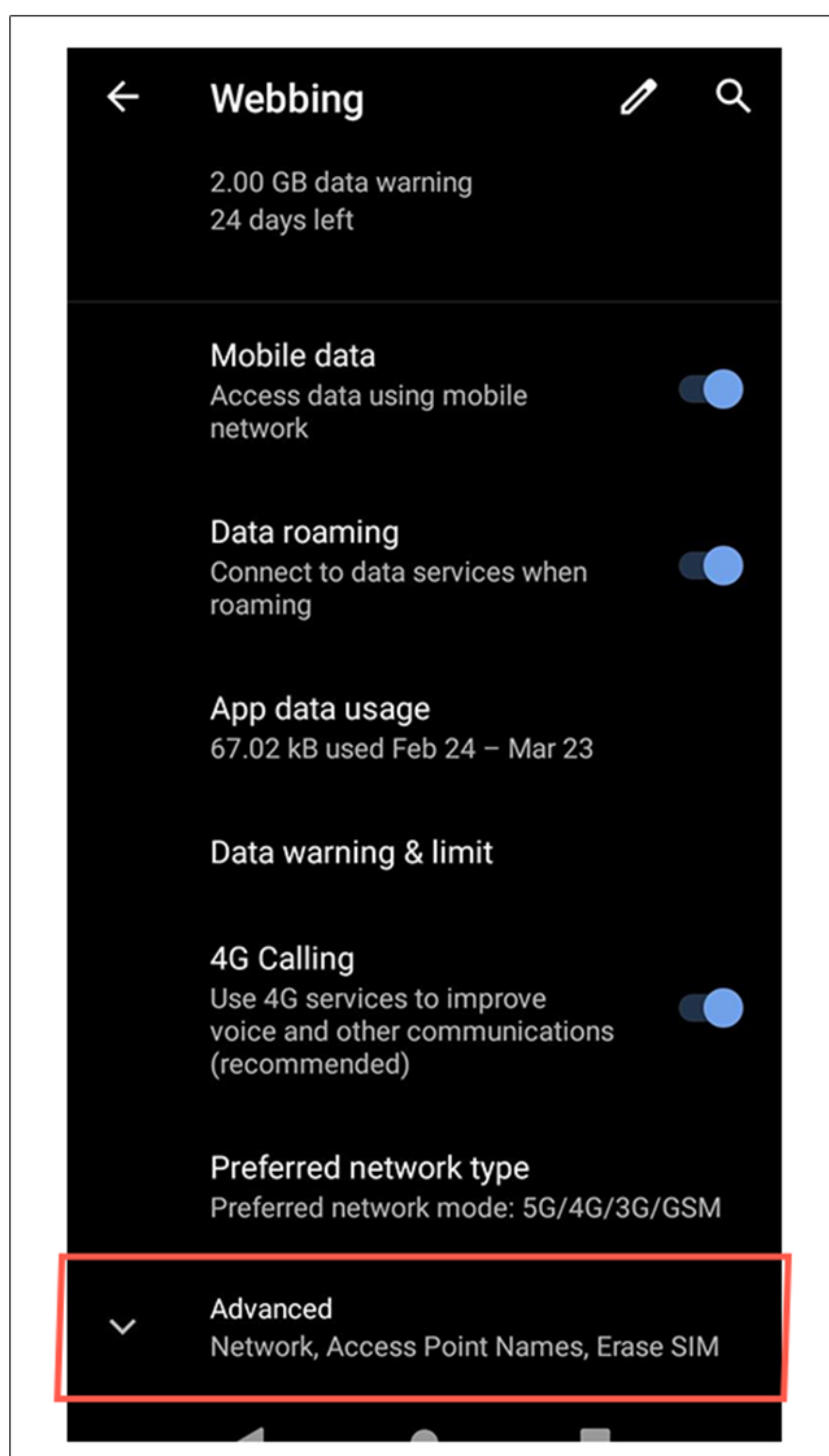

Scroll down, and you should see an "Advanced" option as shown. Please tap it.

STEP 15

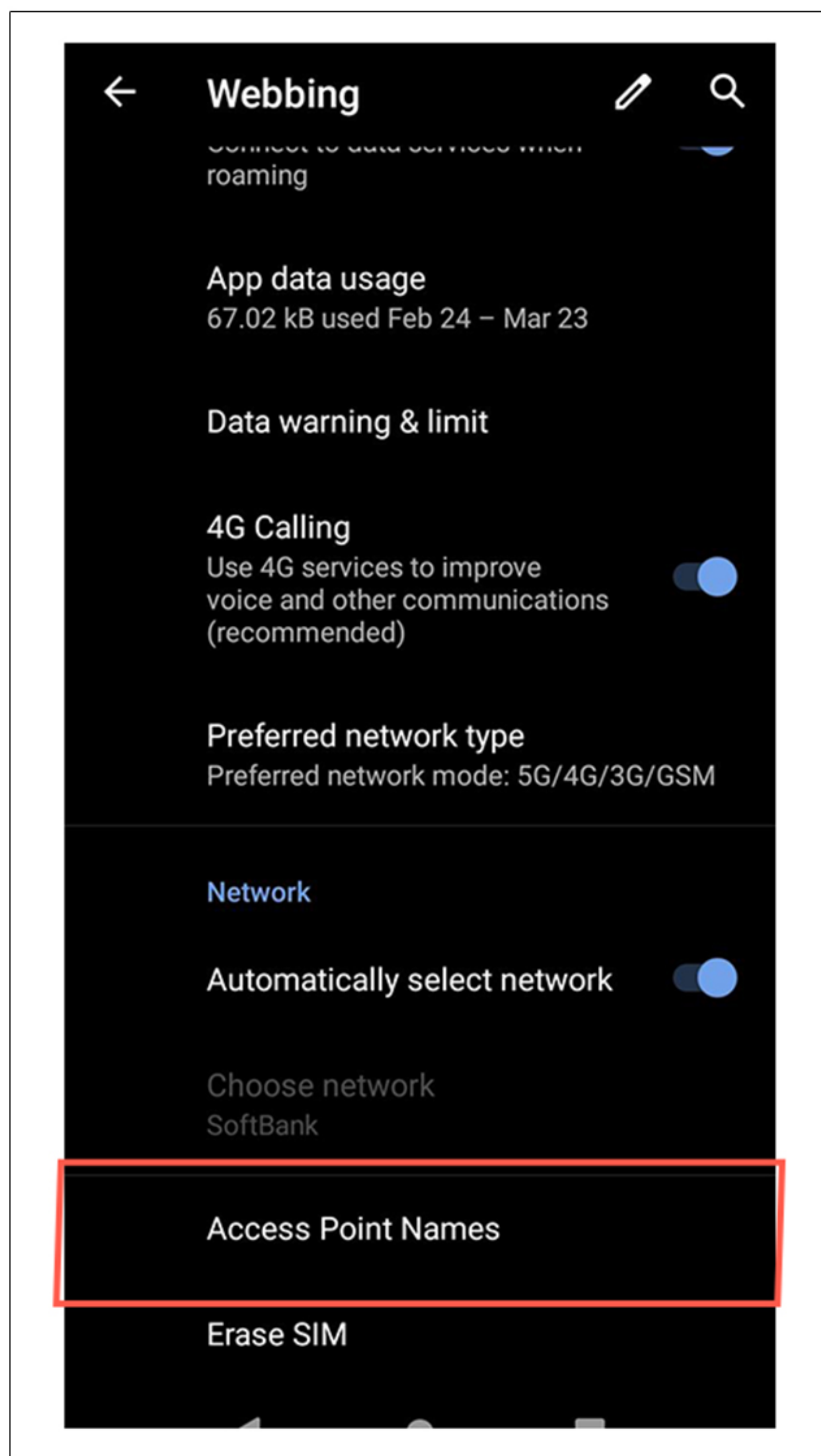

We will now proceed to APN settings.
Please tap "Access Point Names".

STEP 16

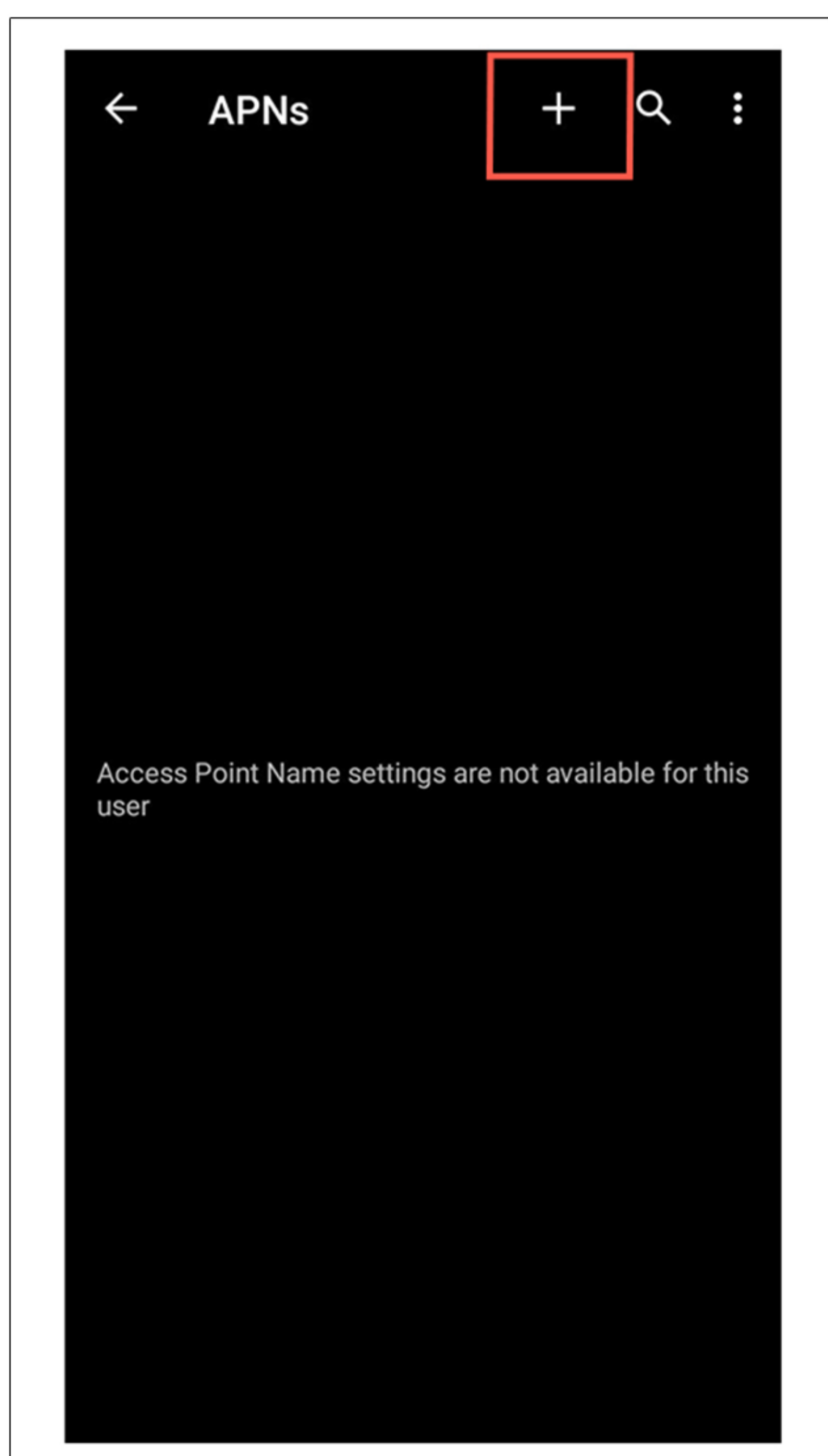

Tap "+".

STEP 17

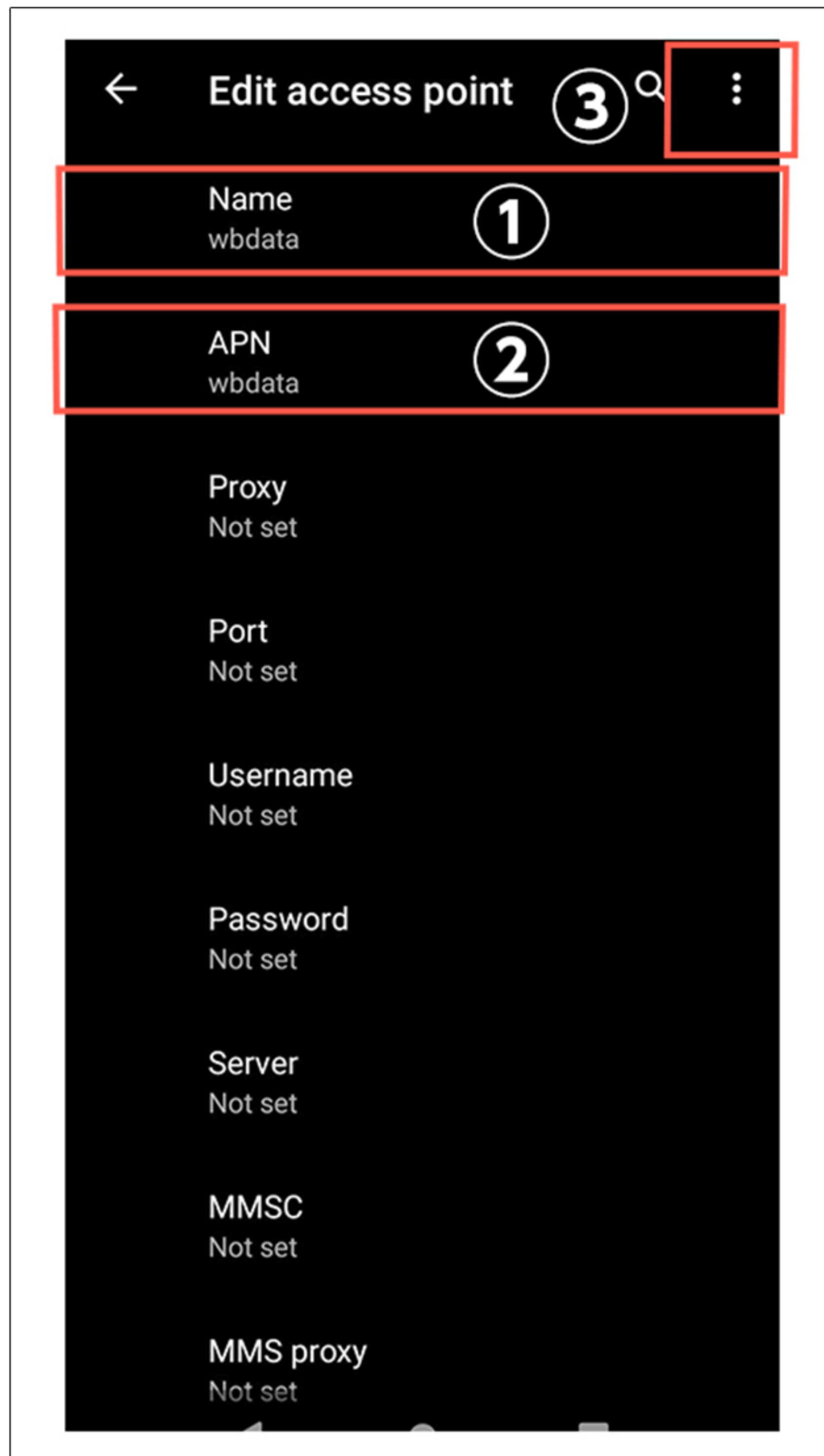

Please enter "①Name" and "②" APN" fields respectively.

Name: Any name is allowed.
APN: Enter the APN sent by email.

After both fields have been entered, tap ③.

STEP 18

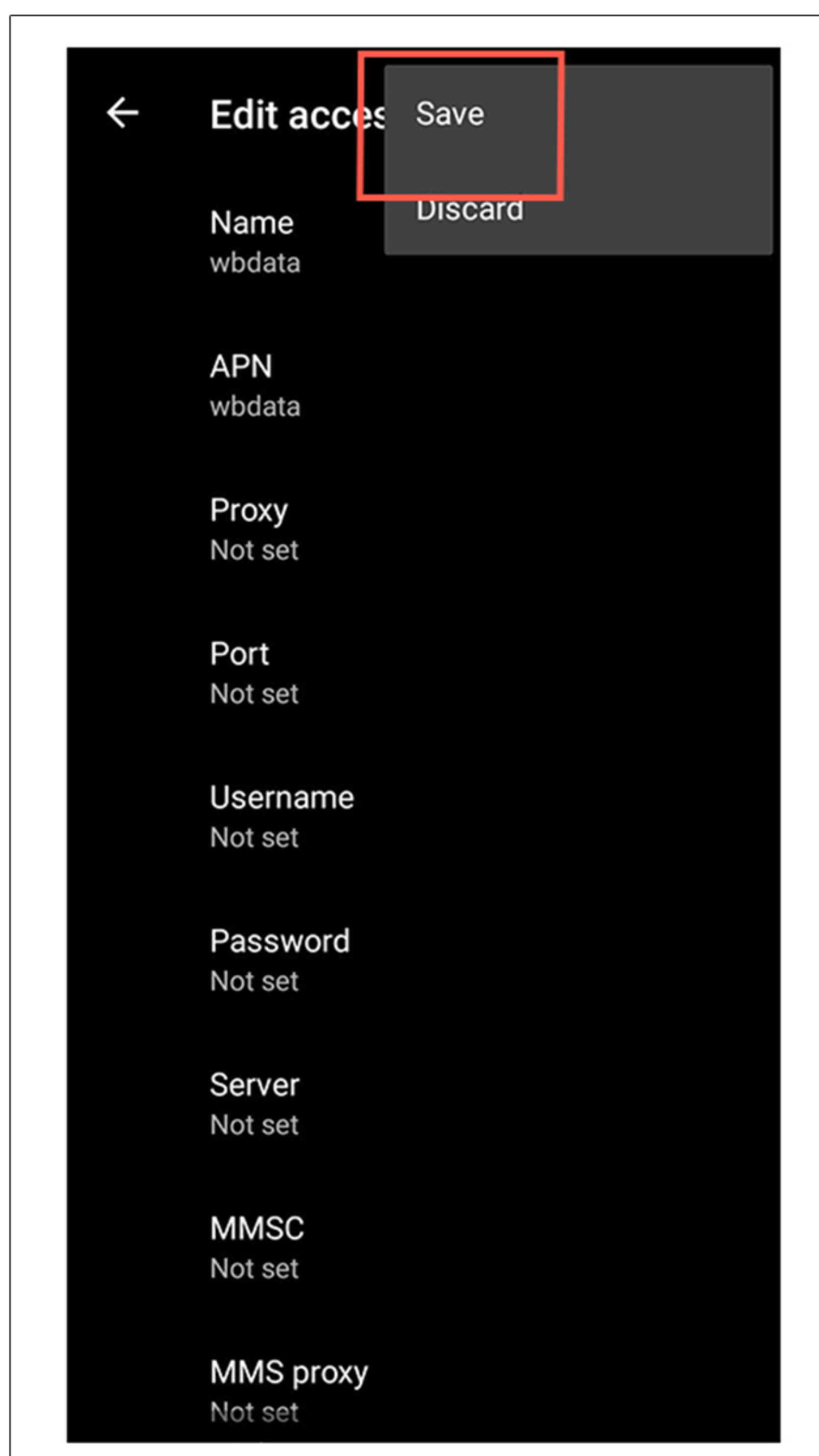

Click on "Save".

Setup is now complete.

It may take about 10 minutes to authenticate.

Setup is now complete.